

C65B01 (CD/S1-01)

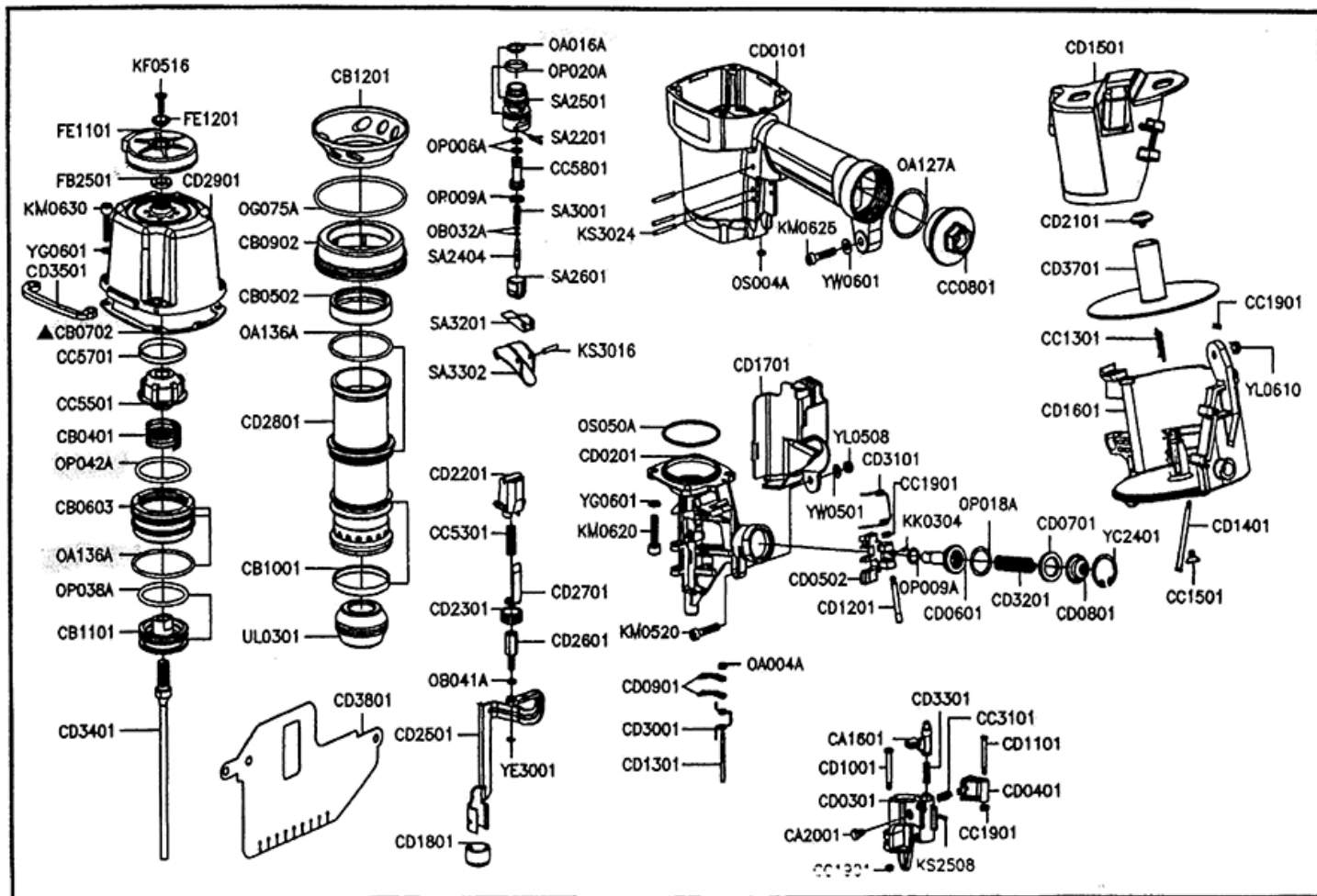

Part_No	Description	Spec	Qty	Part_No	Description	Spec	Qty	Part_No	Description	Spec	Qty
CA1601	DOOR LATCH		1	CD1401	PIN		1	KS3024	SPRING PIN	§ 3-24L	3
CA2001	GROMMET		1	CD1501	CANISTER COVER		1	OA004A	O-RING	ARP568-004	1
CB0401	COMPRESSION SPRING		1	CD1601	CANISTER		1	OA016A	O-RING	ARP568-016	1
CB0502	CYLINDER RING		1	CD1701	TRIP COVER		1	OA127A	O-RING	ARP568-127	1
CB0603	HEAD VALVE PISTON		1	CD1801	PLATE		1	OA136A	O-RING	ARP568-136	3
▲CB0702	CAP SEAL		1	CD2101	SPRING RECEIVER		1	OB032A	O-RING	§ 2.5x1.4	2
CB0902	CYLINDER RING		1	CD2201	SAFETY SET		1	OB041A	O-RING	§ 4.2x1.2	1
CB1001	CHECK SEAL		1	CD2301	ADJUSTING WHEEL		1	OG075A	O-RING	G75	1
CB1101	MAIN PISTON		1	CD2501	CONTACT ARM(A)		1	OP006A	O-RING	P6	2
CB1201	COLLAR		1	CD2601	ADJUSTING PIN		1	OP009A	O-RING	P9	2
CC0801	END CAP		1	CD2701	CONTACT ARM(B)		1	OP018A	O-RING	P18	1
CC1301	PULL SPRING		1	CD2801	CYLINDER		1	OP020A	O-RING	P20	1
CC1501	SPRING RECEIVER		1	CD2901	CYLINDER CAP		1	OP038A	O-RING	P38	1
CC1901	BUSHING		4	CD3001	SPRING		1	OP042A	O-RING	P42	1
CC3101	SPRING		1	CD3101	SPRING		1	OS004A	O-RING	S4	1
CC5301	SAFETY SPRING		1	CD3201	COMPRESSION SPRING		1	OS050A	O-RING	S50	1
CC5501	PISTON STOP		1	CD3301	COMPRESSION SPRING		1	SA2201	STOP PIN		2
CC5701	SPACER		1	CD3401	DRIVER		1	SA2404	TRIGGER VALVE STEM		1
CC5801	PILOT VALVE		1	CD3501	WEAR PLATE		2	SA2501	TRIGGER VALVE SEAT		1
CD0101	BODY		1	CD3701	FIXED SEAT		1	SA2601	TRIGGER VALVE SEAT		1
CD0201	NOSE		1	CD3801	DUST SHIELD		1	SA3001	SPRING		1
CD0301	DOOR		1	FB2501	PISTON STOP		1	SA3201	CONTACT LEVER		1
CD0401	HOLDING PAWL		1	FE1101	EXHAUST CAP		1	SA3302	TRIGGER		1
CD0502	FEED PAWL		1	FE1201	EXHAUST CAP RING		1	UL0301	BUMPER		1
CD0601	FEED PISTON CAP		1	KF0516	FLAT HD.BOLT	M5x0.8-16L	1	YC2401	C-RING	§ 24	1
CD0701	PISTON BUMPER		1	KM0620	HEX.SOC.HD.BOLT	M6x1.0-20L	4	YE3001	E-RING	§ 3.0	1
CD0801	FEED PISTON CAP		1	KM0625	HEX.SOC.HD.BOLT	M6x1.0-25L	1	YG0601	SPRING WASHER	§ 6	8
CD0901	HOLDING PAWL		2	KM0630	HEX.SOC.HD.BOLT	M6x1.0-30L	4	YL0508	LOCK NUT	M5x0.8	1
CD1001	PIN		1	KM0625	HEX.SOC.HD.BOLT	M6x1.0-25L	1	YL0610	LOCK NUT	M6x1	1
CD1101	CHECK PAWL PIN		1	KS2508	SPRING PIN	§ 2.5-8L	1	YW0501	FLAT WASHER	§ 5	1
CD1201	FEED PAWL PIN		1	KS3016	SPRING PIN	§ 3-16L	1	YW0601	FLAT WASHER	§ 6	1
CD1301	CHECK PAWL PIN		1								

★ ☆ If you need to order parts, please mark both Parts No. and Description. † ★