

A-Plus

F18/50C32 (FB/S2-32)

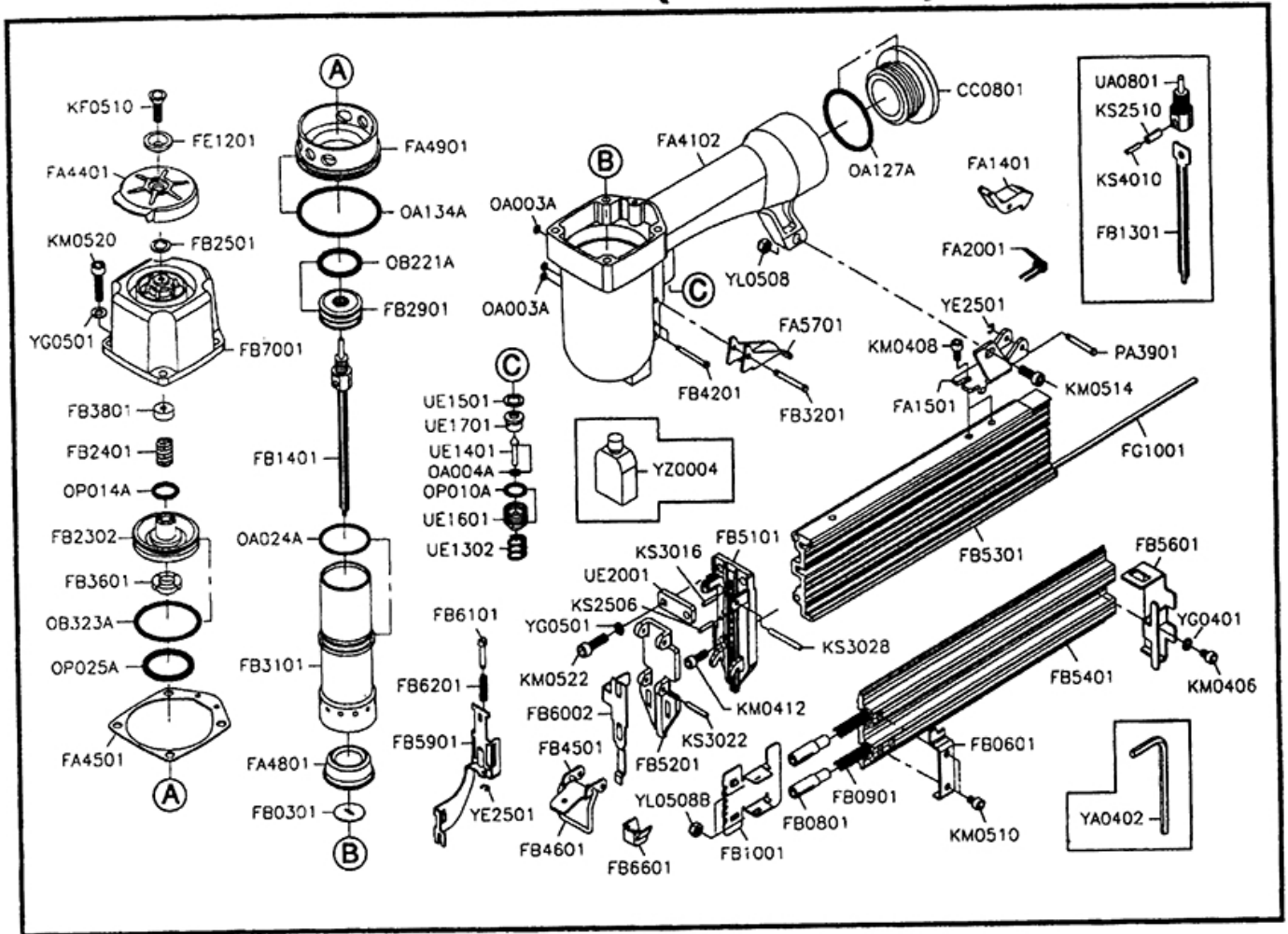

Part No	Description	Spec	Qty	Part No	Description	Spec	Qty	Part No	Description	Spec	Qty
CC0801	END CAP		1	FB4601	FIXED PIN		1	KS4010	SPRING PIN	φ 4.0-10L	1
FA1401	LATCH		1	FB5101	GUIDE PLATE		1	OA003A	O-RING	ARP568-003	3
FA1501	SUPPORT		1	FB5201	DOOR		1	OA004A	O-RING	ARP568-004	1
FA2001	LATCH SPRING		1	FB5301	MAGAZINE SEAT		1	OA024A	O-RING	ARP568-024	1
FA4102	BODY		1	FB5401	MAGAZINE CAP		1	OA127A	O-RING	ARP568-127	1
FA4401	EXHAUST CAP		1	FB5601	STOP PLATE		1	OA134A	O-RING	ARP568-134	1
FA4501	CAP SEAL		1	FB5901	SAFETY(B)		1	OB221A	O-RING	22x 3	1
FA4801	BUMPER		1	FB6002	SAFETY(A)		1	OB323A	O-RING	31.8x 2.4	1
FA4901	COLLAR		1	FB6101	SAFETY SPRING SHAFT		1	OP010A	O-RING	P10	1
FA5701	TRIGGER		1	FB6201	SAFETY SPRING		1	OP014A	O-RING	P14	1
FB0301	NOZZLE		1	FB6601	SAFETY CUSHION		1	OP025A	O-RING	P25	1
FB0601	PUSHER STOP		1	FB7001	CYLINDER CAP		1	PA3901	LATCH PIN		1
FB0801	PUSHER PIN		2	FE1201	EXHAUST CAP RING		1	UA0801	STEM		1
FB0901	PUSHER SPRING		2	FG1001	BAR		1	UE1302	COMPRESSION SPRING		1
FB1001	PUSHER		1	KF0510	BUTTON HD.BOLT	M5x 0.8-10L	1	UE1401	TRIGGER VALVE STEM		1
FB1301	DRIVER		1	KM0406	HEX.SOC.HD.BOLT	M4x 0.7-6L	1	UE1501	SEAL		2
FB1401	DRIVER ASSY.		1	KM0408	HEX.SOC.HD.BOLT	M4x 0.7-8L	2	UE1601	TRIGGER VALVE GUIDE		1
FB2302	HEAD VALVE PISTON		1	KM0412	HEX.SOC.HD.BOLT	M4x 0.7-12L	2	UE1701	TRIGGER VALVE SEAT		1
FB2401	COMPRESSION SPRING		1	KM0510	HEX.SOC.HD.BOLT	M5x 0.8-10L	2	UE2001	SPACER		1
FB2501	PU WASHER		1	KM0514	HEX.SOC.HD.BOLT	M5x 0.8-14L	1	YA0402	HEX BAR WRENCH	D4	1
FB2901	MAIN PISTON		1	KM0520	HEX.SOC.HD.BOLT	M5x 0.8-20L	4	YE2501	E-RING	φ 2.5	2
FB3101	CYLINDER		1	KM0522	HEX.SOC.HD.BOLT	M5x 0.8-22L	2	YG0401	SPRING WASHER	φ 4	1
FB3201	TRIGGER PIN		1	KS2506	SPRING PIN	φ 2.5-6L	1	YG0501	SPRING WASHER	φ 5	6
FB3601	PISTON STOP		1	KS2510	SPRING PIN	φ 2.5-10L	1	YL0508	LOCK NUT	M5x 0.8	1
FB3801	SEAL		1	KS3016	SPRING PIN	φ 3-16L	2	YL0508B	LOCK NUT	M5x 0.8	2
FB4201	PIN		2	KS3022	SPRING PIN	φ 3-22L	1	YZ0004	OIL BOX		1
FB4501	LATCH ASSY.		1	KS3028	SPRING PIN	φ 3-28L	1				

☆☆ If you need to order parts, please mark both Parts No. and Description. ☆☆